

# HUNTERS<sup>®</sup>

HERE TO GET *you* THERE



## Marina Heights

Pearl Lane, Gillingham, ME7 1FA

£1,150 Per Calendar Month



Situated on a modern development close to Gillingham Marina with lots of local amenities including an ASDA superstore and Dockside Outlet with an array of shops restaurants bars gyms and a cinema. The apartment comprises of an open plan living room and kitchen with doors to the balcony, double bedroom which will have a newly laid carpet and bathroom. The apartment itself is located on the second floor of the block which can be accessed via a lift with allocated parking. Available from 16 March 2026.

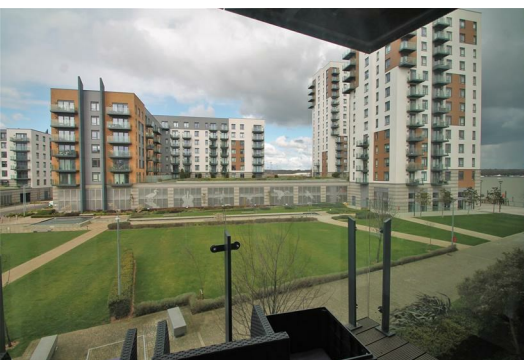

BEDROOM  
BEDROOM

KITCHEN  
KITCHEN

LIVING ROOM  
LIVING ROOM

BATHROOM  
BATHROOM

Area Map



Floor Plans

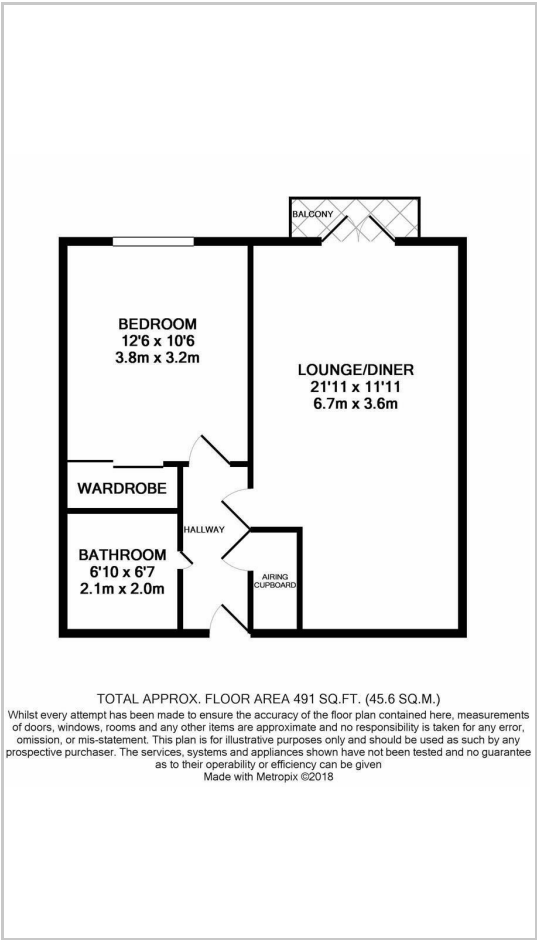

Energy Efficiency Graph

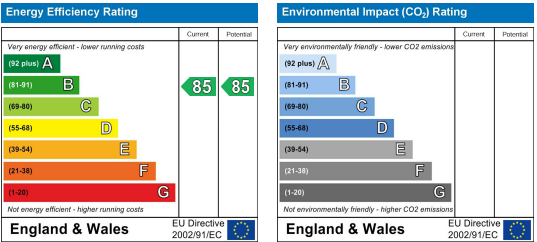

These particulars are intended to give a fair and reliable description of the property but no responsibility for any inaccuracy or error can be accepted and do not constitute an offer or contract. We have not tested any services or appliances (including central heating if fitted) referred to in these particulars and the purchasers are advised to satisfy themselves as to the working order and condition. If a property is unoccupied at any time there may be reconnection charges for any switched off/disconnected or drained services or appliances - All measurements are approximate.

**THINKING OF SELLING?** If you are thinking of selling your home or just curious to discover the value of your property, Hunters would be pleased to provide free, no obligation sales and marketing advice. Even if your home is outside the area covered by our local offices we can arrange a Market Appraisal through our national network of Hunters estate agents.